

# Motorized Slider Tray for Ultra Short Throw(UST) Projector



## User Guide

Thank you for choosing our product.

For your safety and to ensure correct operation, please read this manual thoroughly before use.

To get the most out of your product, please take a moment to familiarize yourself with its functions.

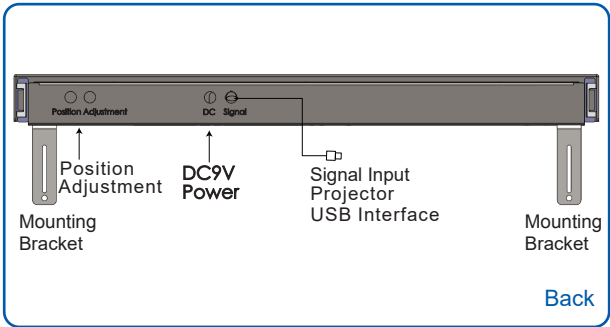
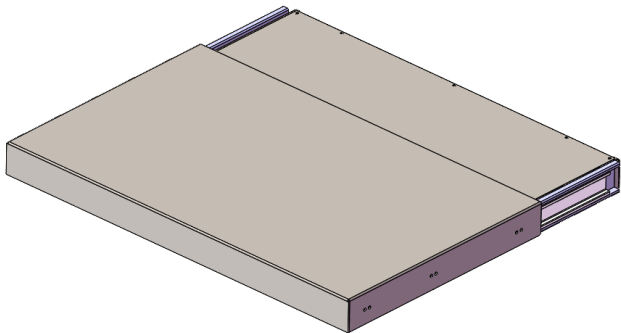

## Important Installation Note:

**The tray must be securely mounted to the wall or desktop using the provided mounting brackets. It must not be left suspended or unsupported!**

**\* Power-On Sound Notice**

You will hear a soft hum when the device is plugged in. This is completely normal and means the system is performing a self-check and activating its anti-pinch safety feature.

## Specification

Name	Auto Telescopic Retractable Tray
Capacity	25KG
Power	DC 9V 1.3 A
Control	USB
Packing List	Tray: 1 pcs Mounting Bracket: 2 pcs Power Cable: 1 pcs Signal Cable: 1 pcs User Guide: 1 pcs Screws: 1 pack  Additional Tool Require : Power Drill /Measuring Tape

## Installation

- Step 1: Preparation**
- Ensure you have the mounting tray and all necessary tools ready, including the required screws.
- Step 2: Assemble Tray & Bracket**
- Attach the mounting bracket to the tray using the provided screws.
- Step 3: Mount the Bracket**
- Position the tray so it is aligned with the center of your TV bench. Secure the bracket to the back of the TV bench.
- Note: If there is no gap between your TV bench and the wall, the bracket can be reversed and mounted directly to the wall.
- Step 4: Place & Connect Projector**
- Place the ultra-short-throw laser projector onto the tray. Connect the projector to the power supply and input signal source.
- Step 5: Initialize & Set Position**
- Turn on the projector. Connect the tray to power.
- Using the "position adjustment" button on the tray, move the projector to its optimal viewing distance by retracting or extending it.
- Wait for at least 30 seconds to allow the tray to save the current projector position.
- Unplug the power cable from the tray. Wait for another 30 seconds.
- Step 6: Final Startup**
- Reconnect the power cable to the tray to restart it. Once restarted, connect the signal cable to the projector. The setup process is now complete.

## **ATTENTION**

### **Important:**

**The tray must be securely mounted to the wall or desktop using the provided mounting brackets.**

**It must not be left suspended or unsupported!**